



# Forward Control Set

## Yamaha XV-series

Art. no. 492-603



### Components

1	Frame mounting plate	2x
2	Shift / brake lever	2x
3	Footpeg	2x
4	Allenhead cone bolt M8 x 30mm	2x
5	Foot peg mounting	2x
6	Connection part	2x
7	Allenhead bolt M10 x 25mm (fine 1,25)	2x
8	Spacer Ø35 x 40mm	2x
9	Washer M12	2x
10	Thin washer M12 (not in all sets)	(2x)
11	Bolt M12 x 70mm	2x
12	Shift / brake peg	2x
13	Washer M8	2x
14	Allenhead bolt M8 x 20mm	2x
15	Ball joint M6	3x
16	Nut M6	7x
17	Brake bar	1x
18	Connection part for brake bar	1x
19	Springwasher M6	1x
20	Allenhead bolt M6 x 30mm	1x
21	Spacer for mounting bar (special part)	2x
22	Mounting bar M10	1x
23	Capnut M10	2x
24	Washer M10	3x
25	Special big nut M10	1x
26	Bolt M10 x 20 (fine 1,25)	1x
27	Control bar	1x

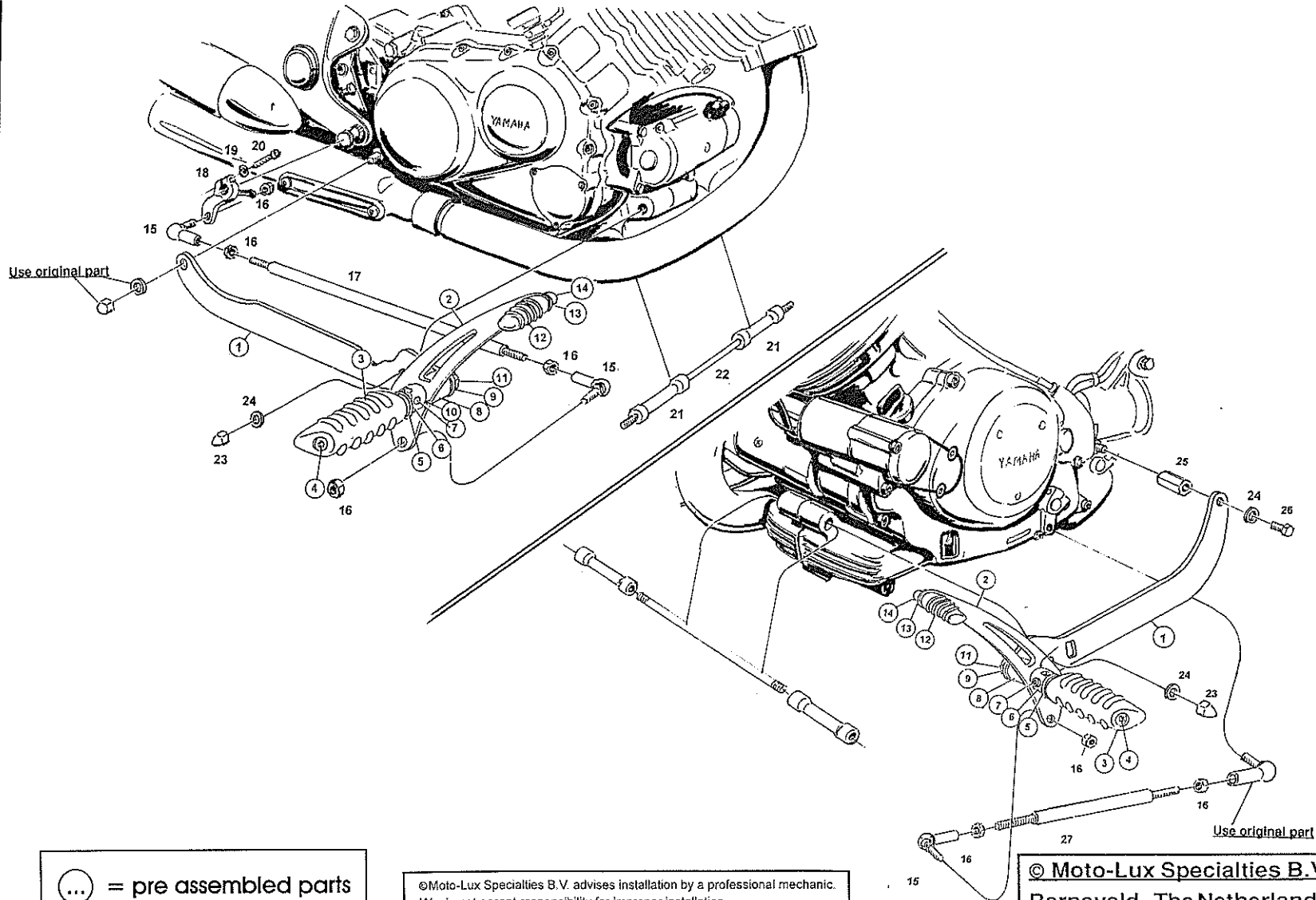

⊙ = pre assembled parts

©Moto-Lux Specialties B.V. advises installation by a professional mechanic.  
We do not accept responsibility for improper installation.

© Moto-Lux Specialties B.V.  
Barneveld - The Netherlands